

SELF-COLLECTION INSTRUCTIONS for Rectal/Anal Swabs

Testing for Chlamydia, Gonorrhoea and Other Bacterial Infections

Purpose of the Test:

This test detects Chlamydia and Gonorrhoea—common STIs—and other bacterial infections.

Important notes:

- Ensure you're in a clean and private space
- Follow each step carefully for accurate results

Self-collection instructions (rectal/anal swabs)

1



Wash your hands with soap and water, or disinfect with hand sanitiser.

2



Remove the swab from the tube. Holding the coloured end, gently insert the swab about 3 cm into the rectum, past the anal sphincter (you might feel some resistance). Turn the swab once.

3

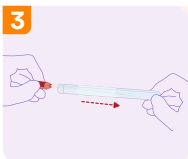

Remove the swab and place it into the provided tube.

4



Wash your hands again with soap and water, or disinfect with hand sanitiser.

5



Label the tube with your full name, date of birth, collection site (rectal/anal), and the time and date of collection.